

## Williamson Manufacturing product news.

The time has come to replace the 100 series injection mould tools. The current tools have been producing parts for over 20 years. Whilst we re-tooled we have taken the opportunity to add some new & improved features:

- **NEW TUBE GRIPS RETAINED IN COVER GIVING EASIER FITMENT OF LONG OR CONTINUOUS TUBE.**
- **PUMP BASE PLATE RETAINED WITH SINGLE SCREW ENABLING EASIER DISASSEMBLY & REASSEMBLY.**
- **3<sup>RD</sup> FIXING AVAILABLE STABILISING THE ASSEMBLY ESPECIALLY WITH A STACKED PUMP.**
- **SPACERS SUPPLIED WITH STACKED UNITS FOR BETTER STABILITY & ASTHETICS.**

OLD 100 SERIES PUMP HEAD

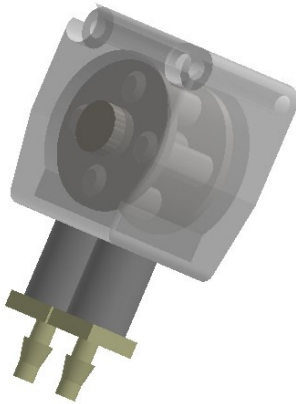

REPLACEMENT 100 SERIES

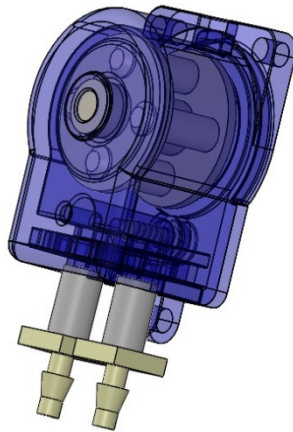

STACKED 100 SERIES

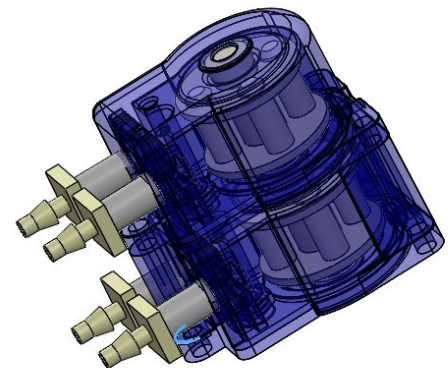

The new 100 series mounts on the same fixing centres and is the same width as the old 100 series. The only change is the old pump head mounted using M3 x 25 screws, the replacement uses M3 x 6. It also has the same rotor arrangement for fitting to 3mm D and 4 mm D shafts and will fit all the existing brackets and motors.

### Dimensions:

